

Product Installation Guidelines

Document Number: 001.00.70.13
Version 1, 4 November 2022, Page 1 of 4

BS Lever Action SBA

PRODUCT CODES:

- 46638 - 46714
- 46642 - 46722
- 46649 - 46726
- 46656 - 46730
- 46664 - 46748
- 46672 - 46755
- 46680 - 46763

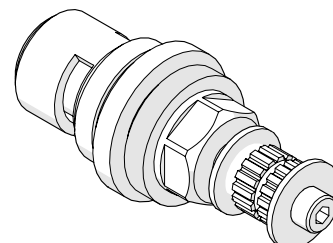

SPECIFICATIONS

- The Galvin Engineering CliniLever® product range is primarily used for hand washing applications in hospitals, aged care facilities, schools and in-home care.
- CliniLever® products provide state of the art features to comply with the latest healthcare guidelines.
- The main body is made of solid dezincification resistant (DR) brass rod, with a DR brass fixed outlet.
- Quick action SBA's include ceramic cartridge components

IMPORTANT: All CliniLever® Healthcare taps are tested in accordance with AS/NZS 3718 and leave our premises in good working order.

TECHNICAL DATA

| | | |
|------------------------------|----------------------------|-----|
| Inlet | G 5/8" BSP – Male | |
| Outlet | N/A | |
| Headwork | Jumper Valve/ Ceramic Disc | |
| Working Pressure Range (kPa) | Min | 50 |
| | Max | 500 |
| Working Temperature (°C) | Min | 5 |
| | Max | 65 |
| Nominal Flow Rate (LPM) | N/A | |
| Finish | Brass | |

NOTE: Galvin Engineering continually strive to improve their products. Specifications may change without notice.

TOOLS REQUIRED

- Spanner and hex key
- Thread tape

INSTALLATION

IMPORTANT: Galvin Specialised products must be installed in accordance with these installation instructions and in accordance with AS/NZS 3500, the PCA and your local regulatory requirements. Water and/or electrical supply conditions must also comply to the applicable national and/or state standards. Failing to comply with these provisions shall void the product warranty and may affect the performance of the product.

Note: Tapware body used as an example only. SBAs can fit on different kinds of Ezy-Wash bodies.

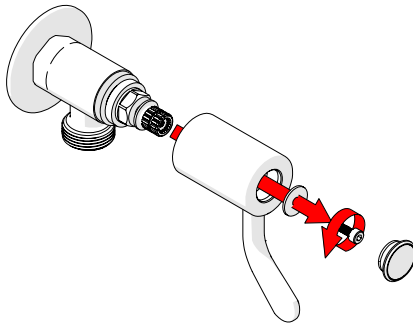

1. Remove Handle

- Prior to installation turn off the water supply.
- Remove the handle assembly. To prevent damage, carefully pry off plastic indicator from the handle. (Use a small flat bladed screwdriver if necessary).

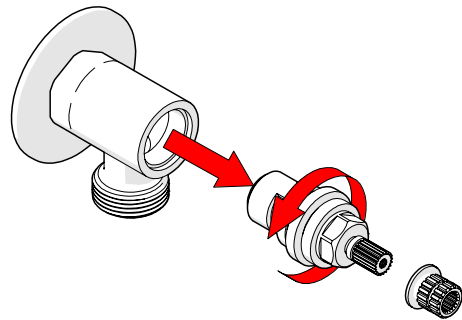

2. Replace spindle assembly

- Unscrew the head part from the threaded sleeve using a 17mm spanner.
- Check seat inside tap body for pitting or damage. Re-seat if necessary

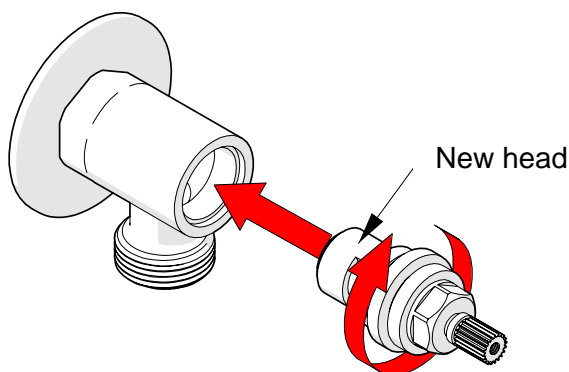

3. Refit new head

- Refit new head into tap body.

Note: do not tighten cartridge using the handle as this will result in damage to the cartridge

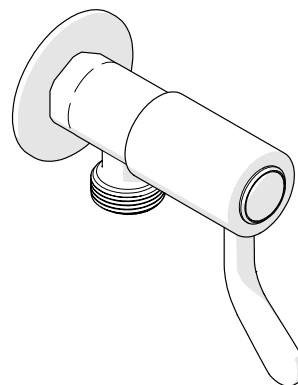

4. Reassemble Handle

- Refit adaptor and reassemble handle by reversing step 1.
- When installation is complete, slowly open water supply and inspect for leaks.

| TROUBLESHOOTING | | |
|-------------------------------|---|--|
| PROBLEM | CAUSE | RECTIFICATION |
| Taps are dripping water | Jumper valves are worn or damaged | Replace jumper valve |
| | Ceramic discs are worn or damaged | Remove and inspect SBA. Remove debris and/or replace SBA if damaged. |
| | Tap seat is damaged | Refurbish tap seat using a reseating tool. |
| Water is leaking from spindle | O-ring on jumper valve spindle is damaged or worn | Replace o-ring |
| Water is not flowing from tap | Water is turned off | Turn on water |
| | Ceramic discs are worn or damaged | Remove and inspect SBA. Remove debris and/or replace SBA if damaged. |
| Spindle is difficult to turn | Ceramic discs are worn or damaged | Remove and inspect SBA. Remove debris and/or replace SBA if damaged. |
| | Build up of scale on spindle, spindle worn or o-ring has been damaged | Remove jumper valve, clean and regrease. Replace o-ring. Complete SBA may need to be replaced. |
| Handle is loose | Screw has come loose | Tighten handle screw |

WARRANTY

The warranty set forth herein is given expressly and is the only warranty given by the Galvin Engineering Pty Ltd. With respect to the product, Galvin Engineering Pty Ltd makes no other warranties, express or implied. Galvin Engineering Pty. Ltd. hereby specifically disclaims all other warranties, express or implied, including but not limited to the implied warranties of merchantability and fitness for a particular purpose.

Galvin Engineering Pty Ltd products are covered under our manufacturer's warranty available for download from www.galvinengineering.com.au. Galvin Engineering Pty Ltd expressly warrants that the product is free from operational defects in workmanship and materials for the warranty period as shown on the schedule in the manufacturer's warranty. During the warranty period, Galvin Engineering will replace or repair any defective products manufactured by Galvin Engineering without charge, so long as the terms of the Manufacturer's warranty are complied with.

The remedy described in the first paragraph of this warranty shall constitute the sole and exclusive remedy for breach of warranty, and Galvin Engineering Pty Ltd shall not be responsible for any incidental, special or consequential damages, including without limitation, lost profits or the cost of repairing or replacing other property which is damaged if this product does not work properly, other costs resulting from labour charges, delays, vandalism, negligence, fouling caused by foreign material, damage from adverse water conditions, chemical, electrical or any other circumstances over which Galvin Engineering has no control. This warranty shall be invalidated by any abuse, misuse, misapplication, improper installation or improper maintenance or alteration of the product.

Within Australia: **1300 514 074** Outside Australia: P: **+61 (0)8 9338 2344**

F: **+61 (0)8 9338 2340**

sales@galvinengineering.com.au

www.galvinengineering.com.au

ABN: 78 008 719 382

PERTH | SYDNEY | MELBOURNE | BRISBANE | ADELAIDE

